



CANOPY DOLL CRIB WITH BASKETS, MOBILE, & BEDDING

Assembly and Use Instructions. Adult Assembly Required. Read all instructions before use.

This manual is part of the product and must be saved for future reference.



MODEL NUMBER*:
01723

VERSION CODE*:
8.0/0320/TG

** Model and Version numbers are needed if replacement parts are requested*

Find us on  •  **YouTube** *assembly video available at Badger Basket's YouTube channel!*

FOR REPLACEMENT PARTS:
<http://www.badgerbasket.com/parts>

Badger Basket®, PO Box 227, Edgar, WI 54426-0227 USA • **Web:** www.badgerbasket.com
U.S. Based Customer Service Toll-Free (Mon-Thurs 7:00 AM-4:00 PM CST): 1-800-236-1310
Phone: 715-352-2311 • **Fax:** 715-352-3163



BEFORE YOU BEGIN ASSEMBLY:

Check all parts. If anything is missing or not satisfactory, please DO NOT call the store or return the product to them. Please go online to:
<http://www.badgerbasket.com/parts>

Most problems are resolved without you needing to leave home. When emailing or calling us, please have this instruction manual, your product model number, and your Version Code ready.

Your Model Number is: 01723

Your Version Code is: 8.0/0320/TG

CARE INSTRUCTIONS:

Frame can be wiped clean with a damp cloth and mild soap and dry thoroughly. Spot clean or hand wash fabric as needed with cold water and mild detergent and allow to air dry. Spot clean baskets with cold water and mild detergent and air dry. Never immerse the baskets in water.



WARNING

ADULT ASSEMBLY REQUIRED. DUE TO THE PRESENCE OF SMALL PARTS AND SHARP POINTS DURING ASSEMBLY, KEEP OUT OF REACH OF CHILDREN UNTIL ASSEMBLY IS COMPLETE.



WARNING - CAUTION

READ ALL INSTRUCTIONS before use of this product. Use only the parts provided by Badger Basket®. Keep instructions for future use.

Do not use the product if it is damaged or broken. Periodically inspect the product to ensure all parts remain tight. **This item is a toy for dolls only. It is never to be used for real infants or pets. No product is a substitute for adult supervision.**

Always supervise your child during play. For children ages three (3) years and older. Never sit on or stand on the toy. **DO NOT** attach the toy mobile to a baby crib or playpen due to possible entanglement or strangulation injury.



ASSEMBLY TIPS! Review the entire manual before beginning. Leave hardware slightly loose during assembly and then go back and tighten fully at the end. If using a power screwdriver, keep torque setting low and go slow to prevent damage to the product.

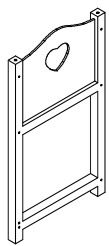

END PANEL
A×2

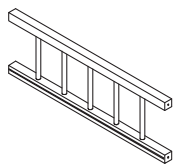

SIDE RAIL
B×2

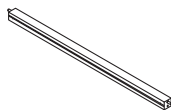

BOTTOM RAIL
C×2

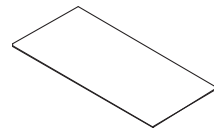

BOTTOM PANEL
D×2



CORNER POST
E×4



CANOPY SUPPORT
F×2

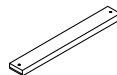

CANOPY SUPPORT
CROSSBAR
G



EYE HOOK
H



MOBILE MUSIC BOX
I

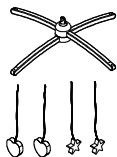

MOBILE CROSSARMS
WITH 4 STRING/SHAPES
J

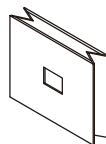

BASKET BODY
K×2

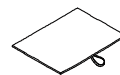

BASKET BOTTOM
PANEL
L×2



FABRIC PILLOW
M

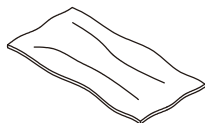

FABRIC BLANKET
N

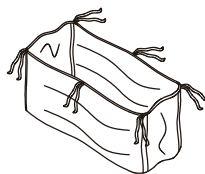

FABRIC
BUMPER/LINER
O

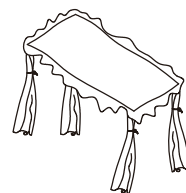

FABRIC CANOPY
P



FABRIC RIBBON
Q×4

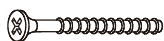

LONG BOLT
R×12



SHORT BOLT
S×6

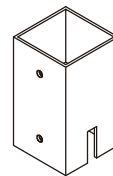

POST
CONNECTOR RIGHT
T×2

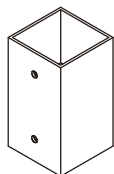

POST CONNECTOR
LEFT
U×2



SCREW
V×8

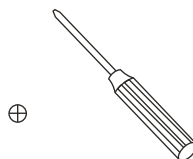

PHILLIPS SCREWDRIVER
TOOL
(NOT INCLUDED)

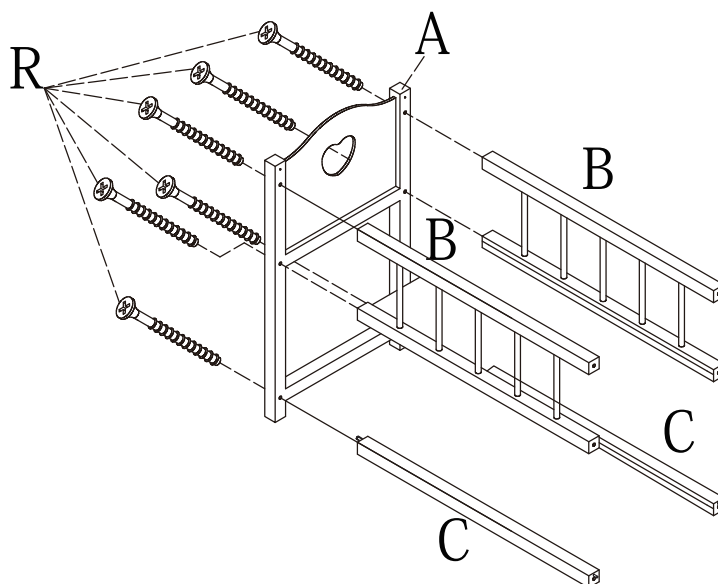

(1)



R × 6

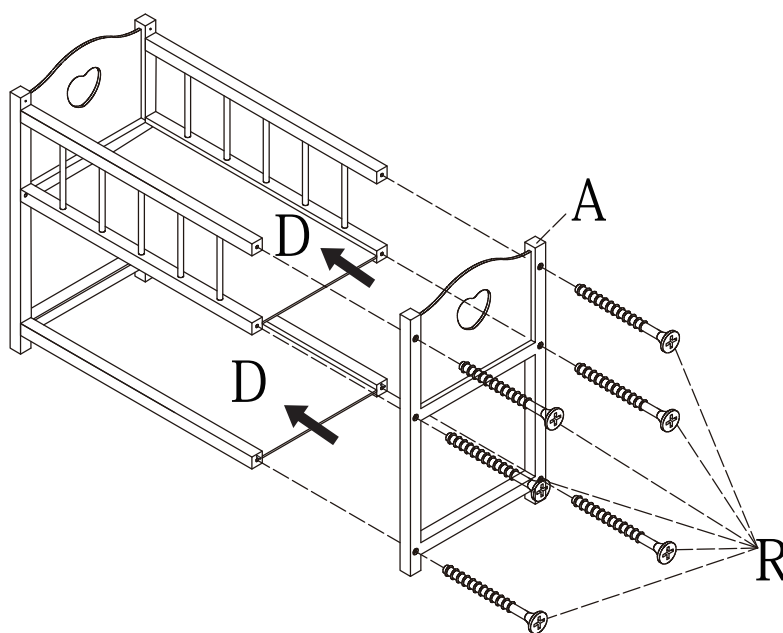

(2)

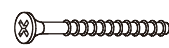

R × 6

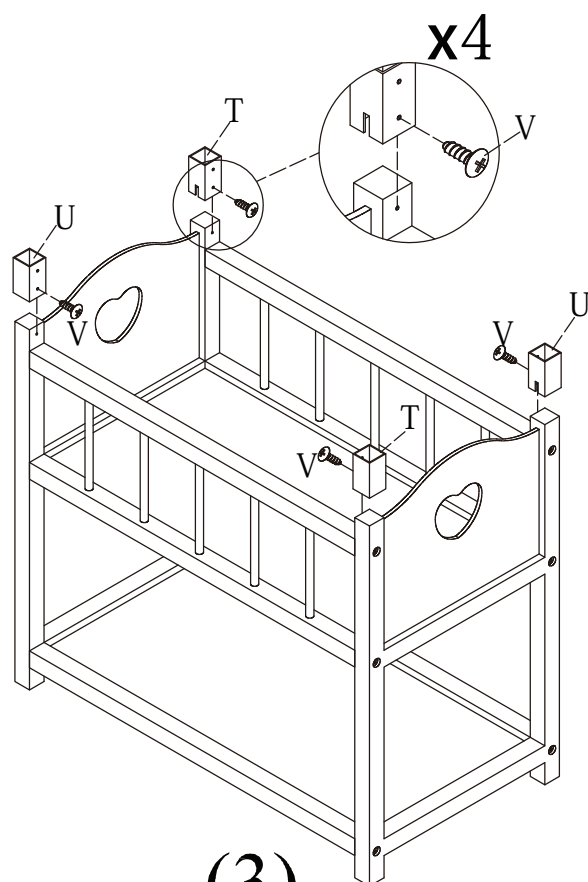

(3)

V × 4

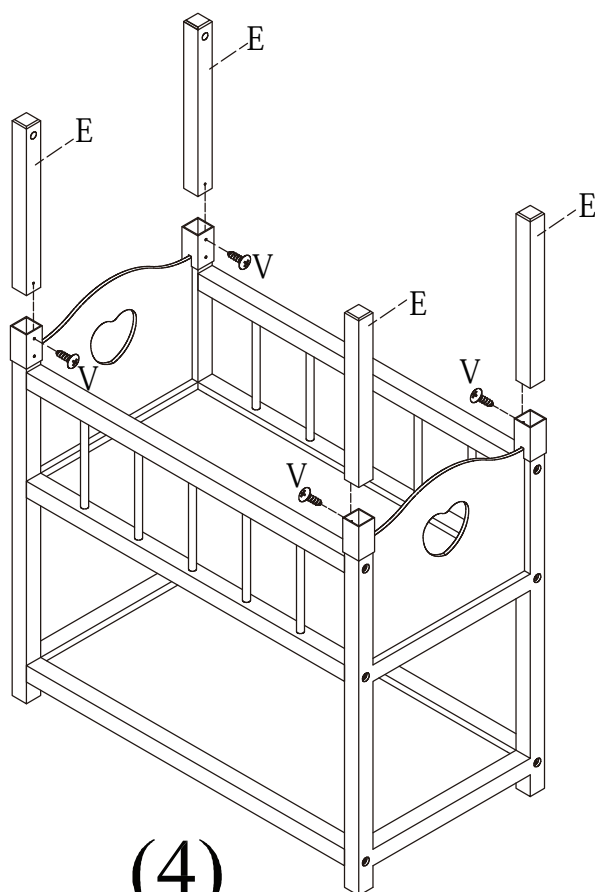

(4)

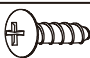
V × 4

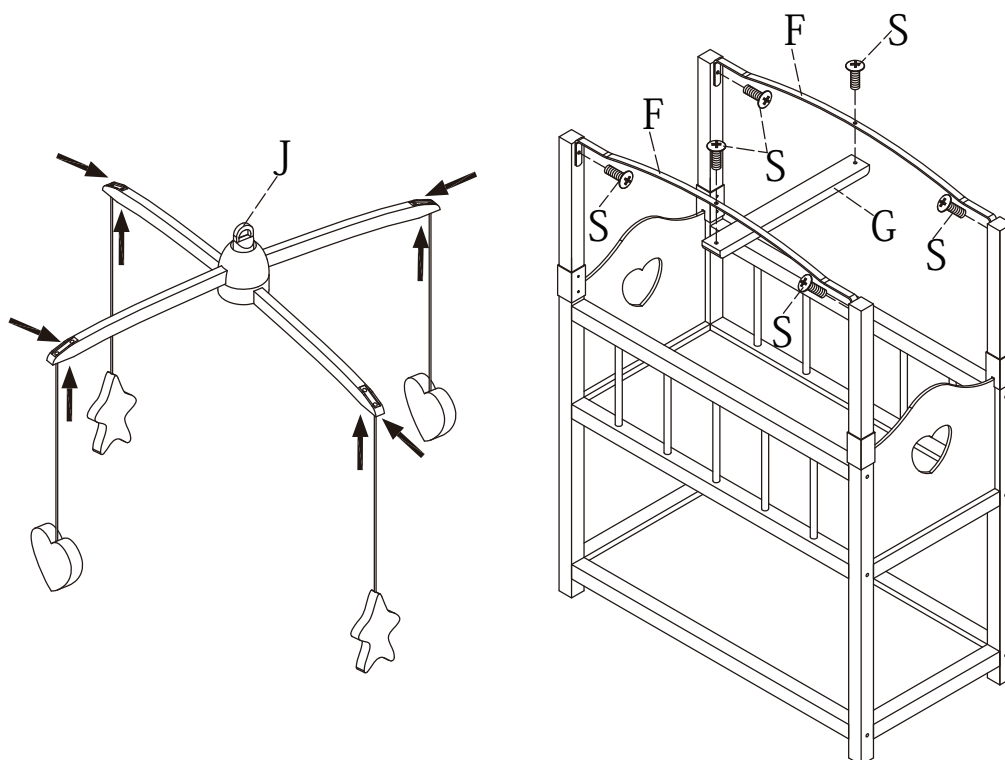

(5)

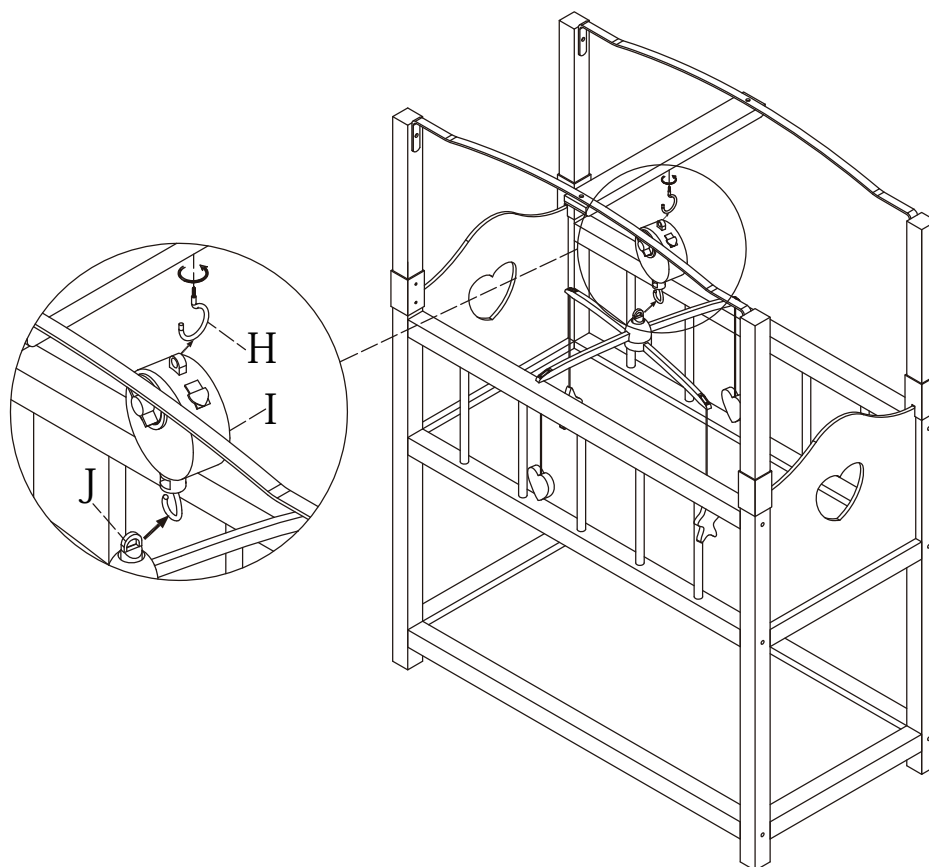

S × 6

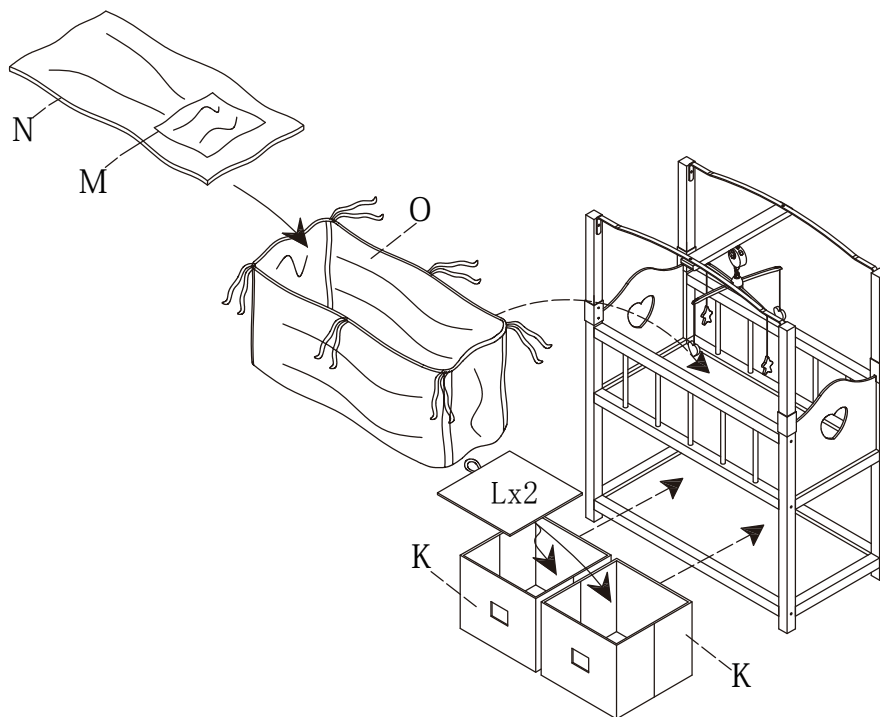

(6)

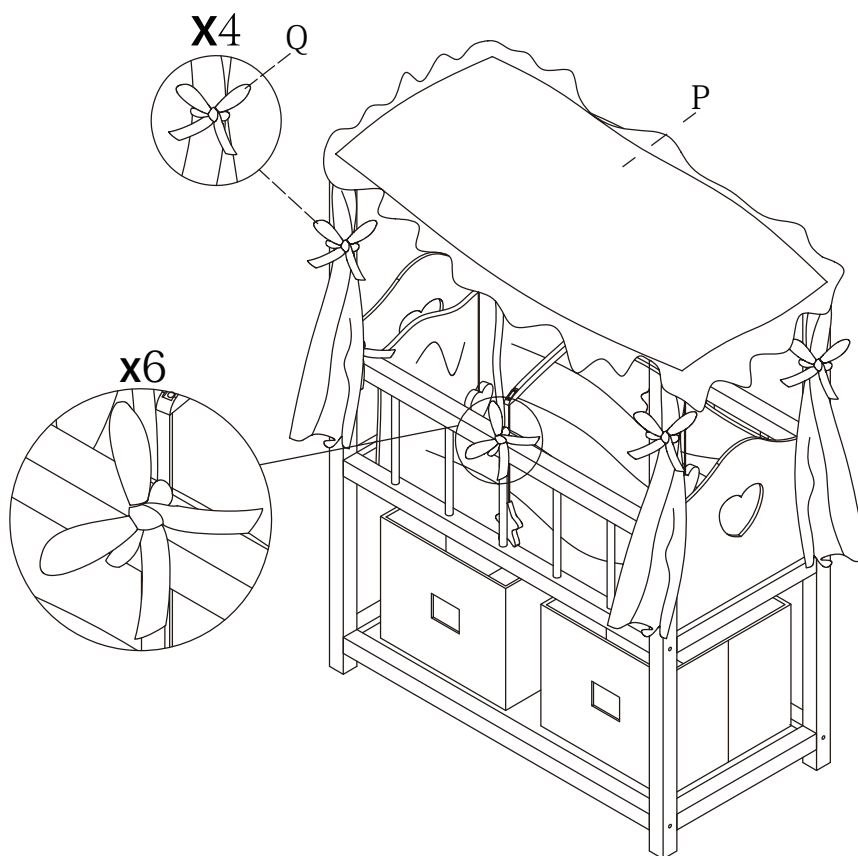

(7)



(8)